

# HILAMAN'S OIL SPRING SUBD.

# MALTA TOWNSHIP SECTION 33 R-12 TWP-10 MORGAN COUNTY, OH

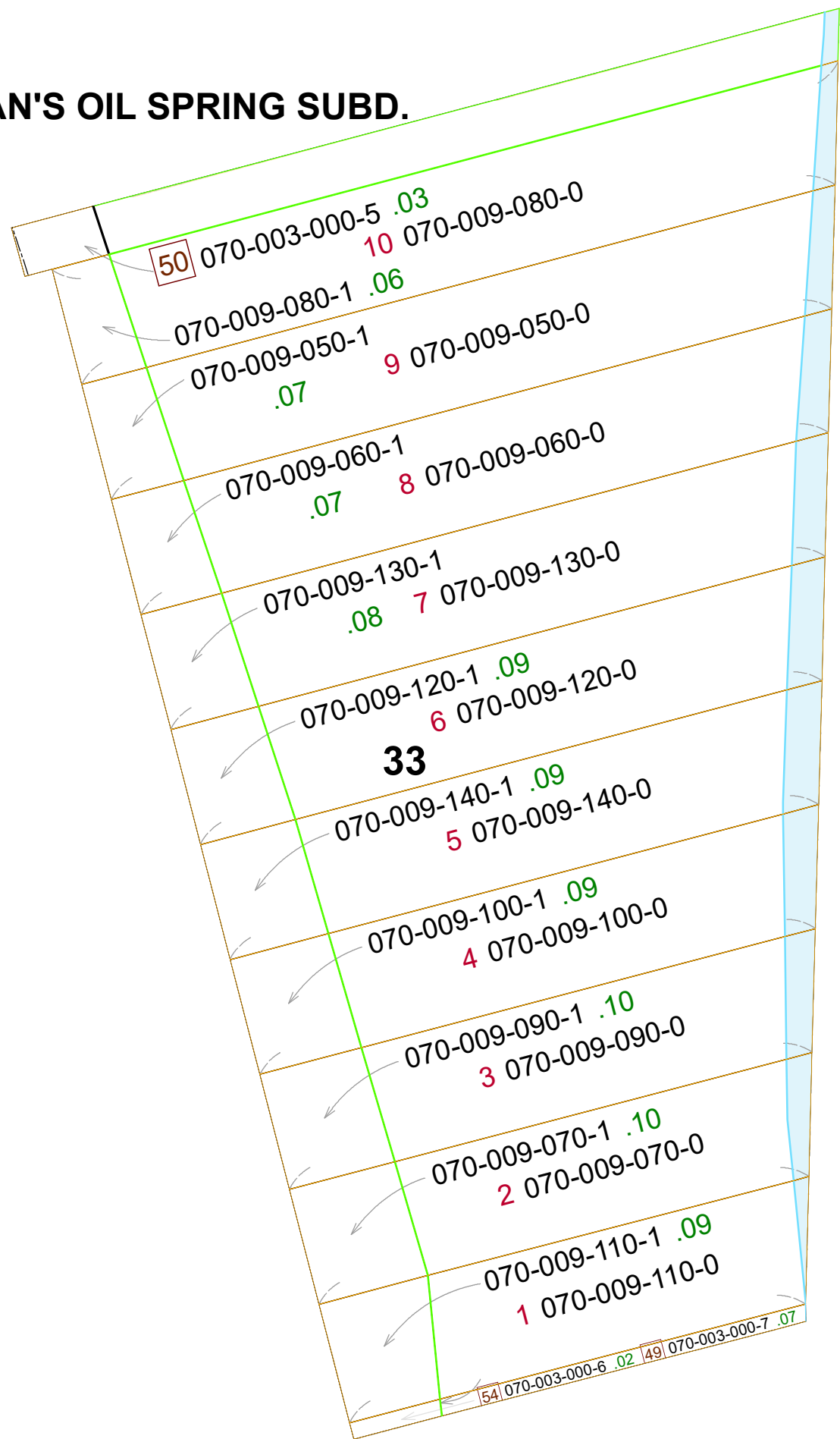

PIN	VOL	PAG	Owner	LegalDescr	Acres
070-009-140-0	OR230	2375	ALLEN CRETA & MICHAEL ZINK	HILAMAN'S OIL SPRING SD IN LOT 5 E	0
070-009-060-0	OR181	100	GILMER JUDIE M	HILAMAN'S OIL SPRINGS SD IN LOT 8	0
070-003-000-7	OR203	154	HILAMAN LILA JEANETTE TOD-CHRISTO	R12 T11 S33 SD 49	0.067
070-009-090-0	OR214	2973	MARTIE DENNIS L	HILAMAN'S OIL SPRING SD IN LOT 3 E	0
070-009-100-0	OR214	2973	MARTIE DENNIS L	HILAMAN'S OIL SPRING SD IN LOT 4 E	0
070-009-120-0	OR229	2586	SAUNDERS RICKY WAYNE	HILAMAN'S OIL SPRING SD IN LOT 6 E	0
070-009-130-0	OR229	2586	SAUNDERS RICKY WAYNE	HILAMAN'S OIL SPRING SD IN LOT 7 E	0
070-003-000-6	D.V 198	624	STATE OF OHIO/ODOT	R12 T11 S33 SD 54	0.015
070-009-110-1	OR198	633	STATE OF OHIO/ODOT	HILAMAN'S OIL SPRING SD LOT 1A	0.092
070-009-070-1	D.V 198	624	STATE OF OHIO/ODOT	HILAMAN'S OIL SPRING SD LOT 2A	0.098
070-009-090-1	D.V 198	624	STATE OF OHIO/ODOT	HILAMAN'S OIL SPRING SD LOT 3A	0.095
070-009-100-1	D.V 198	624	STATE OF OHIO/ODOT	HILAMAN'S OIL SPRING SD LOT 4A	0.092
070-009-140-1	D.V 198	624	STATE OF OHIO/ODOT	HILAMAN'S OIL SPRING SD LOT 5A 38	0.089
070-009-120-1	D.V 198	624	STATE OF OHIO/ODOT	HILAMAN'S OIL SPRING SD LOT 6A 36	0.085
070-009-130-1	D.V 198	624	STATE OF OHIO/ODOT	HILAMAN'S OIL SPRING SD LOT 7A 33	0.078
070-009-060-1	D.V 198	624	STATE OF OHIO/ODOT	HILAMAN'S OIL SPRING SD LOT 8A	0.071
070-009-050-1	D.V 198	618	STATE OF OHIO/ODOT	HILAMAN'S OIL SPRING SD LOT 9A	0.065
070-009-080-1	D.V 198	621	STATE OF OHIO/ODOT	HILAMAN'S OIL SPRING SD LOT 10A	0.058
070-003-000-5	D.V 198	621	STATE OF OHIO/ODOT	R12 T11 S33 SD 50	0.034
070-009-110-0	OR232	5907	SUSAN B MCKNIGHT LIVING TRUST	HILAMAN'S OIL SPRINGS SD IN LOT 1	0
070-009-070-0	OR232	5907	SUSAN B MCKNIGHT LIVING TRUST	HILAMAN'S OIL SPRING SD IN LOT 2 E	0
070-009-050-0	OR225	2057	WOHRLE PATRICK E & VERA S DENNEY	HILAMAN'S OIL SPRING SD IN LOT 9 S	0
070-009-080-0	OR225	2059	WOHRLE PATRICK E & VERA S DENNEY	HILAMAN'S OIL SPRING SD IN LOT 10	0

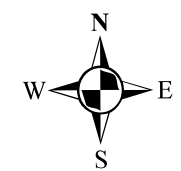

**Boundaries**

- Hidden
- Roads
- County
- Hydro
- Lot
- Parcel
- Section
- Township
- Parcels

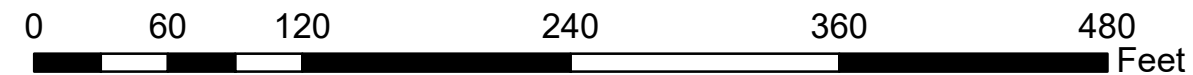

Disclaimer: The information that these maps contains is for reference purposes only. Please bring any erros to the attention of the Engineer's Office staff.  
Thank you

Source: Morgan County Engineer's Office  
Author: Marcia Wolfe  
Date: 6/25/2020